

WIRING DIAGRAM STANDARD LIQUID LEVEL CONTROL

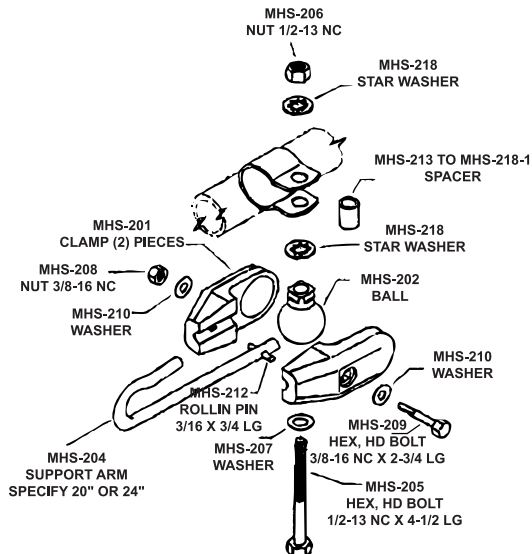
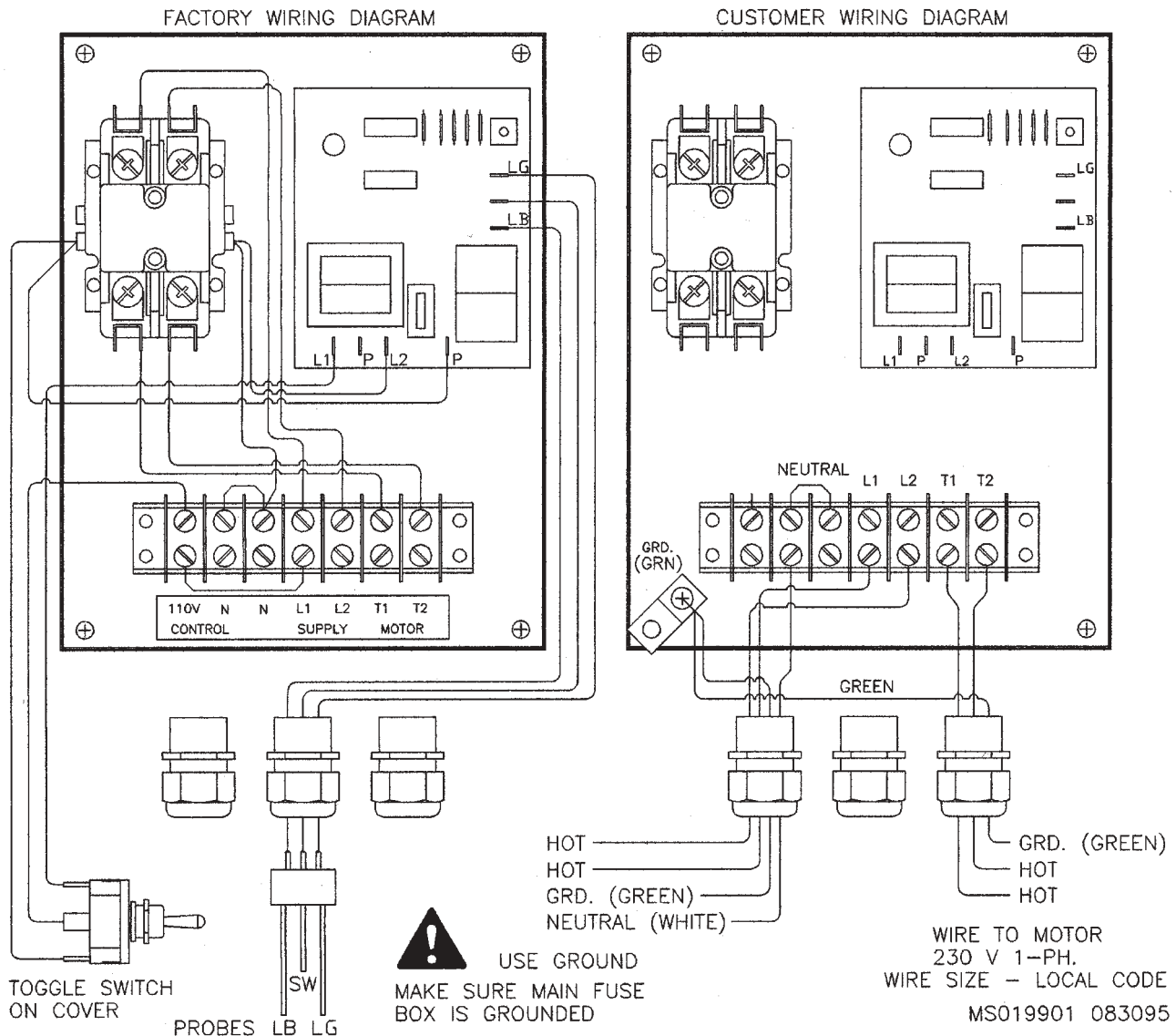

HOSE SUPPORT ARMS - Now Available for 2-3/8" Pipe

Long Wearing Nylon Ball. The best...easiest to use for milking parlors.

20" - UNIT COMPLETE PART # 21030
24" - UNIT COMPLETE PART # 21029

DESCRIPTION	PART #
Clamp set to enclose ball	21032
Nylon ball	21033
Clamp for rail	21034
Complete knuckle assy. less arm	21037
20" Arm only	21031
24" Arm only	21039
MH-213 Clamp w/spacer (1-5/8")	21032-1
MHS-215 Clamp w/spacer (2-3/8")	21032-2
MHS-218 Star Washer	21032-3

